

FIELD AND SUSTAINMENT MAINTENANCE
REPAIR PARTS AND SPECIAL TOOLS LIST

TRUCK, CARGO: 2-1/2-TON, 6X6, M44A2 SERIES TRUCKS (MULTIFUEL)

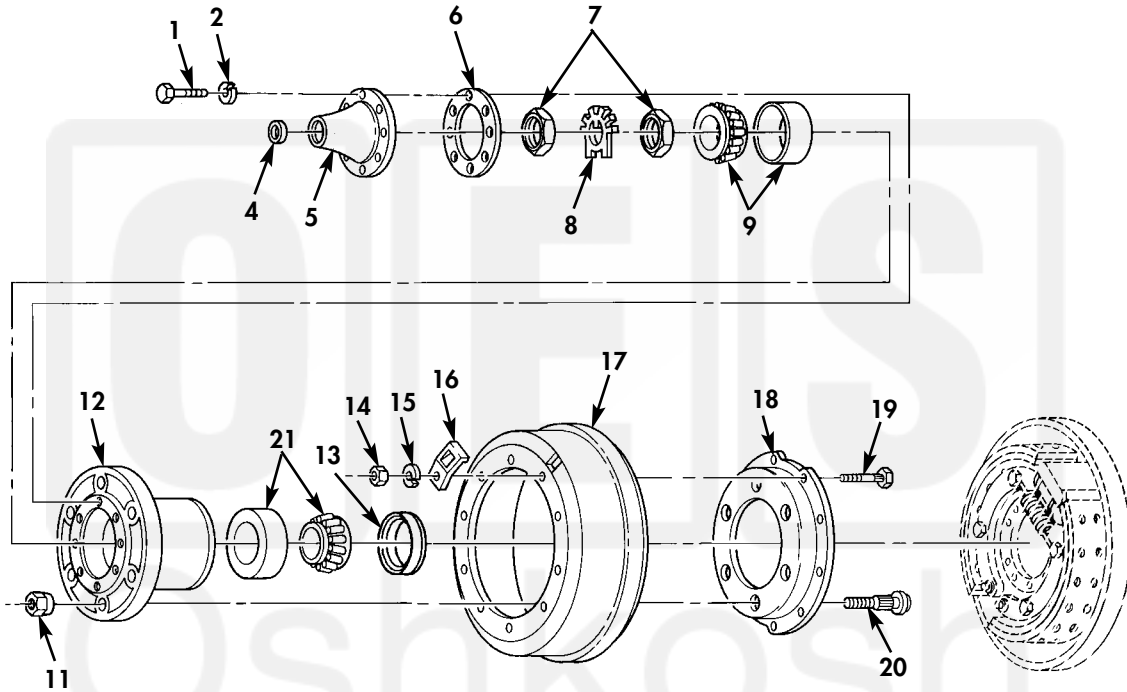
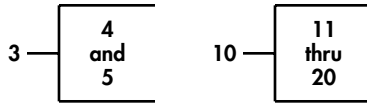

Figure 92. Front Wheel Hub and Drum Assembly.

(1) ITEM NO	(2) SMR CODE	(3) NSN	(4) CAGEC	(5) PART NUMBER	(6) DESCRIPTION AND USABLE ON CODE (UOC)	(7) QTY
GROUP 1311 WHEEL ASSEMBLY						
FIG. 92 FRONT WHEEL HUB AND DRUM ASSEMBLY						
1	PAOZZ	5306-00-182-9267	19207	10896726	BOLT,MACHINE.....	8
2	PAOZZ	5310-00-584-5272	96906	MS35338-48	WASHER,LOCK.....	8
3	PAOZZ	4730-00-752-1861	19207	7521861	FLANGE,PIPE.....	1
4	PAOZZ	5340-00-752-1762	19207	7521762	.PLUG,EXPANSION.....	1
5	PAOZZ	2520-00-087-8891	19207	8757694	.FLANGE,COMPANION,VE.....	1
6	KFOZZ	5330-00-599-4230	19207	7521787	GASKET.....	1
7	PAOZZ	5310-00-752-1633	19207	7521633	NUT,PLAIN,OCTAGON.....	2
8	PAOZZ	5310-00-752-1650	78500	1229G969	WASHER,KEY.....	1
9	PAOZZ	3110-00-087-9881	19207	10948079	BEARING,ROLLER,TAPE.....	1
10	PAOOO	2530-00-193-8187	19207	7529053	HUB,WHEEL,VEHICULAR L.H.....	1
10	PAOOO	2530-00-193-8183	19207	7529054	HUB,WHEEL,VEHICULAR R.H.....	1
11	PAOZZ	5310-01-045-3709	8E499	A32804	.NUT,PLAIN,SINGLE BA.....	6
11	PAOZZ	5310-00-518-5566	58536	A52427-L-0.750	.NUT,PLAIN,SINGLE BA.....	6
12	PAOZZ	2530-00-176-7859	34623	RCSK-14751	.HUB,WHEEL,VEHICULAR.....	1
13	PAOZZ	5330-00-891-7826	19207	10896684	.SEAL,PLAIN ENCASED.....	1
14	PAOZZ	5310-00-732-0559	96906	MS51968-8	.NUT,PLAIN,HEXAGON.....	10
15	PAOZZ	5310-00-637-9541	80205	MS35338-46	.WASHER,LOCK.....	10
16	PAOZZ	5340-00-134-5121	19207	10896733	.COVER,ACCESS.....	1
17	PAOHH	2530-00-288-2986	19207	10896696	.BRAKE DRUM.....	1
18	PAOZZ	2530-00-026-3916	19207	7521636	.ADAPTER,BRAKE DRUM.....	1
19	PAOZZ	5306-00-177-5278	19207	10896689	.BOLT,RIBBED SHOULDE.....	10
20	PAOZZ	5306-00-170-0141	19207	10896719-2	.BOLT,RIBBED SHOULDE R.H. THREAD...	6
20	PAOZZ	5306-01-104-5885	19207	10896719-1	.BOLT,RIBBED SHOULDE L.H. THREAD...	6
21	PAOZZ	3110-00-087-3930	19207	10945151	BEARING,ROLLER,TAPE.....	1

END OF FIGURE

